

ASBESTOS/NON-ASBESTOS GASKET Style No:TFG



The Flat Gaskets are the most typical ones from the family of flat static gaskets. They are used in a large number by various industries and in a variety of applications. The soft gaskets are made of asbestos, non-asbestos, graphite, PTFE, mica, aramide/ graphite and rubber sealing materials. Available are standard according to customer design or sample and nonstandard gasket design. Non-standard means gaskets of optional shapes and dimensions.

The non-metallic gaskets are produced in several sizes and shapes to meet the most demanding applications. They are available in standard and non-standard gasket design. Non-standard means gasket of any shape and size according to customer design.

Inquiry / Order example

Size	Pressure	Material	Qty
1"	150#	Non-asbestos Jointing Gasket, TFN-20,TK:2.0mm	100pcs
DN20	PN16	100% virgin PTFE Gasket, Tk:2.0mm	100pcs

Flat gaskets dimensions for:

- flat face and raised face flanges (IBC)
- male-female flanges (SR)
- tongue and groove flanges (TG)
- flanges with screw holes (FF)

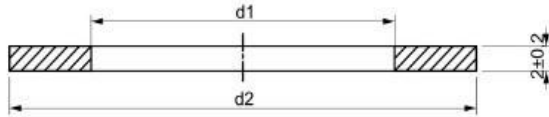

Form IBC, SR, TG

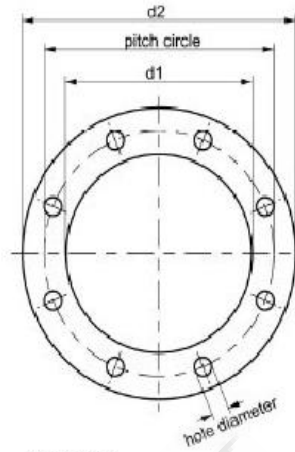

Form FF

Flange / gasket forms:

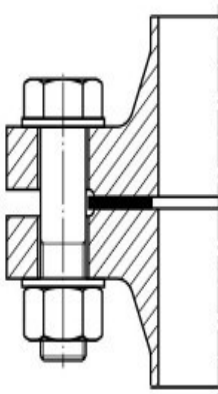

Form IBC
flat face and raised face

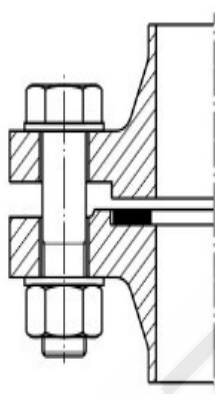

Form SR
male-female

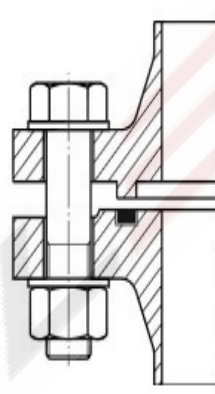

Form TG
tongue and groove

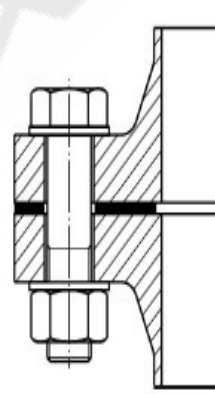

Form FF
with screw holes

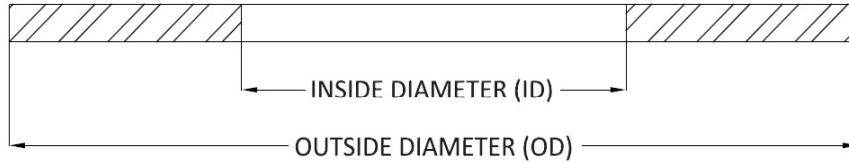

Dimensions for Ring Gaskets per ASME B16.21 to Suit ASME B16.5 Flanges

Nominal Pipe Size (NPS)	Class 150		Class 300		Class 400		Class 600		Class 900	
	Inside Diameter (ID)	Outside Diameter (OD)	Inside Diameter (ID)	Outside Diameter (OD)	Inside Diameter (ID)	Outside Diameter (OD)	Inside Diameter (ID)	Outside Diameter (OD)	Inside Diameter (ID)	Outside Diameter (OD)
	mm	mm	mm	mm	mm	mm	mm	mm	mm	mm
1/2"	21	48	21	54	21	54	21	54	21	64
3/4"	27	57	27	67	27	67	27	67	27	70
1	33	67	33	73	33	73	33	73	33	79
1 1/4	42	76	42	83	42	83	42	83	42	89
1 1/2	49	86	49	95	49	95	49	95	49	99
2	60	105	60	111	60	111	60	111	60	143
2 1/2	73	124	73	130	73	130	73	130	73	165
3	89	137	89	149	89	149	89	149	89	168
3 1/2	102	162	102	165	102	162	102	162	-	-
4	114	175	114	181	114	178	114	194	114	206
5	141	197	141	216	141	213	141	241	141	248
6	168	222	168	251	168	248	168	267	168	289
8	219	279	219	308	219	305	219	321	219	359
10	273	340	273	362	273	359	273	400	273	435
12	324	410	324	422	324	419	324	457	324	498
14	356	451	356	486	356	483	356	492	356	521
16	406	514	406	540	406	536	406	565	406	575
18	457	549	457	597	457	594	457	613	457	638
20	508	607	508	654	508	648	508	683	508	699
24	610	718	610	775	610	768	610	791	610	838

Dimensions for Ring Gaskets per ASME B16.21 to Suit ASME B16.47 Series A Flanges

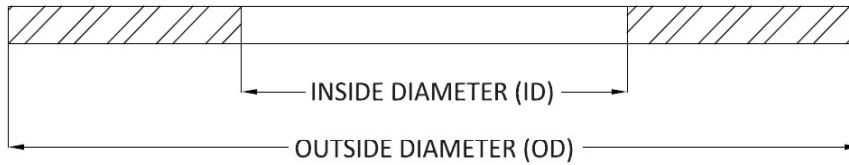

Nominal Pipe Size (NPS)	Class 150		Class 300		Class 400		Class 600	
	Inside Diameter (ID)	Outside Diameter (OD)	Inside Diameter (ID)	Outside Diameter (OD)	Inside Diameter (ID)	Outside Diameter (OD)	Inside Diameter (ID)	Outside Diameter (OD)
	mm	mm	mm	mm	mm	mm	mm	mm
26	660	775	660	835	660	832	660	867
28	711	832	711	899	711	892	711	914
30	762	883	762	953	762	946	762	972
32	813	940	813	1006	813	1003	813	1022
34	864	991	864	1057	864	1054	864	1073
36	914	1048	914	1118	914	1118	914	1130
38	965	1111	965	1054	965	1073	965	1105
40	1016	1162	1016	1115	1016	1127	1016	1156
42	1067	1219	1067	1165	1067	1178	1067	1219
44	1118	1276	1118	1219	1118	1232	1118	1270
46	1168	1327	1168	1273	1168	1289	1168	1327
48	1219	1384	1219	1324	1219	1346	1219	1391
50	1270	1435	1270	1378	1270	1403	1270	1448
52	1321	1492	1321	1429	1321	1454	1321	1499
54	1372	1549	1372	1492	1372	1518	1372	1556
56	1422	1607	1422	1543	1422	1568	1422	1613
58	1473	1664	1473	1594	1473	1619	1473	1664
60	1524	1715	1524	1645	1524	1683	1524	1721

Dimensions for Ring Gaskets per ASME B16.21 to Suit ASME B16.47 Series B Flanges

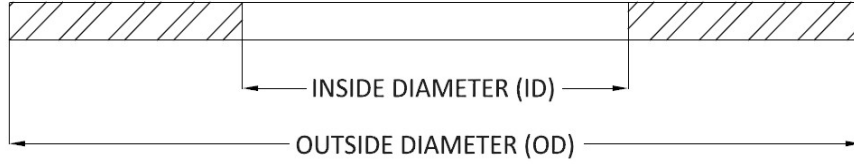

Nominal Pipe Size (NPS)	Class 150		Class 300		Class 400		Class 600	
	Inside Diameter (ID)	Outside Diameter (OD)	Inside Diameter (ID)	Outside Diameter (OD)	Inside Diameter (ID)	Outside Diameter (OD)	Inside Diameter (ID)	Outside Diameter (OD)
	mm	mm	mm	mm	mm	mm	mm	mm
26	660	725	660	772	660	746	660	765
28	711	776	711	826	711	800	711	819
30	762	827	762	886	762	857	762	879
32	813	881	813	940	813	911	813	933
34	864	935	864	994	864	962	864	997
36	914	988	914	1048	914	1022	914	1048
38	965	1044	965	1099				
40	1016	1095	1016	1149				
42	1067	1146	1067	1200				
44	1118	1197	1118	1251				
46	1168	1256	1168	1318				
48	1219	1307	1219	1369				
50	1270	1357	1270	1419				
52	1321	1408	1321	1470				
54	1372	1464	1372	1530				
56	1422	1514	1422	1594				
58	1473	1580	1473	1656				
60	1524	1630	1524	1705				

Dimensions for Full Face Gaskets to Suit ASME B16.5 Flanges

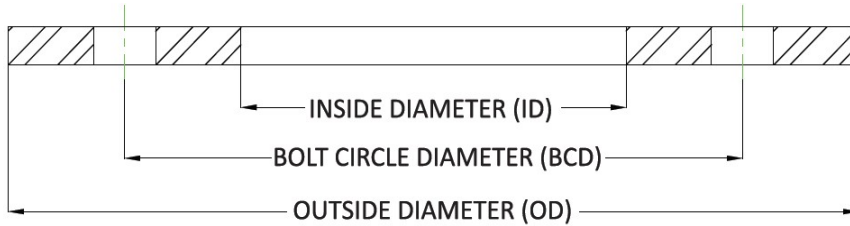

Nominal Pipe Size (NPS)	Class 150					Class 300				
	Inside Diameter (ID)	Outside Diameter (OD)	# of Bolt Holes	Bolt Hole Diameter (Inches)	Bolt Circle Diameter (BCD)	Inside Diameter (ID)	Outside Diameter (OD)	# of Bolt Holes	Bolt Hole Diameter (Inches)	Bolt Circle Diameter (BCD)
	mm	mm	Inches		mm	mm	mm	Inches		mm
1/2"	21	89	4	0.62	60.3	21	95	4	0.63	66.8
3/4"	27	99	4	0.62	69.9	27	117	4	0.75	82.6
1	33	108	4	0.62	79.4	33	124	4	0.75	88.9
1 1/4	42	118	4	0.62	88.9	42	133	4	0.75	98.4
1 1/2	49	127	4	0.62	98.4	49	155	4	0.88	114.3
2	60	152	4	0.75	120.7	60	165	8	0.75	127
2 1/2	73	178	4	0.75	139.7	73	191	8	0.88	149.2
3	89	191	4	0.75	152.4	89	210	8	0.88	168.3
3 1/2	102	216	8	0.75	177.8	102	229	8	0.88	184.2
4	114	229	8	0.75	190.5	114	254	8	0.88	200
5	141	254	8	0.88	215.9	141	279	8	0.88	235
6	168	279	8	0.88	241.3	168	318	12	0.88	269.9
8	219	343	8	0.88	298.5	219	381	12	1	330.2
10	273	406	12	1	362	273	445	16	1.13	387.4
12	324	483	12	1	431.8	324	521	16	1.25	450.9
14	356	533	12	1.12	476.3	356	584	20	1.25	514.4
16	406	597	16	1.12	539.8	406	648	20	1.38	571.5
18	457	635	16	1.25	577.9	457	711	24	1.38	628.7
20	508	699	20	1.25	635	508	775	24	1.38	685.8
24	610	813	20	1.38	749.3	610	914	24	1.63	812.8

Dimensions for Full Face Gaskets to Suit ASME B16.5 Flanges

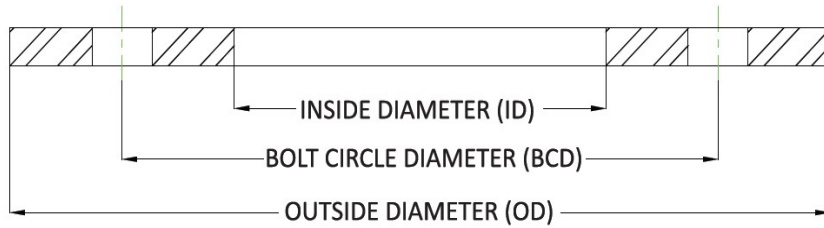

Nominal Pipe Size (NPS)	Class 400					Nominal Pipe Size (NPS)	Class 600				
	Inside Diameter (ID)	Outside Diameter (OD)	# of Bolt Holes	Bolt Hole Diameter (Inches)	Bolt Circle Diameter (BCD)		Inside Diameter (ID)	Outside Diameter (OD)	# of Bolt Holes	Bolt Hole Diameter (Inches)	Bolt Circle Diameter (BCD)
	mm	mm			mm		mm	mm			mm
1/2"	21	95	4	0.63	66.5	1/2"	21	95	4	0.63	66.8
3/4"	27	117	4	0.75	82.6	3/4"	27	117	4	0.75	82.6
1	33	124	4	0.75	88.9	1	33	124	4	0.75	88.9
1 1/4	42	133	4	0.75	98.4	1 1/4	42	133	4	0.75	98.4
1 1/2	49	156	4	0.88	114.3	1 1/2	49	156	4	0.88	114.3
2	60	165	8	0.75	127	2	60	165	8	0.75	127
2 1/2	73	191	8	0.88	149.2	2 1/2	73	191	8	0.88	149.2
3	89	210	8	0.88	168.3	3	89	210	8	0.88	168.3
3 1/2	102	229	8	1	184.2	3 1/2	102	229	8	1	184.2
4	114	254	8	1	200	4	114	273	8	1	215.9
5	141	279	8	1	235	5	141	330	8	1.13	266.7
6	168	318	12	1	269.9	6	168	356	12	1.13	292.1
8	219	381	12	1.13	330.2	8	219	419	12	1.25	349.3
10	273	445	16	1.25	387.4	10	273	508	16	1.38	431.8
12	324	521	16	1.38	450.9	12	324	559	20	1.38	489
14	356	584	20	1.38	514.4	14	356	603	20	1.5	527.1
16	406	648	20	1.5	571.5	16	406	686	20	1.63	603.3
18	457	711	24	1.5	628.7	18	457	743	20	1.75	654.1
20	508	775	24	1.63	685.8	20	508	813	24	1.75	723.9
24	610	914	24	1.88	812.8	24	610	940	24	2	838.2

Dimensions for Full Face Gaskets to Suit ASME B16.5 Flanges

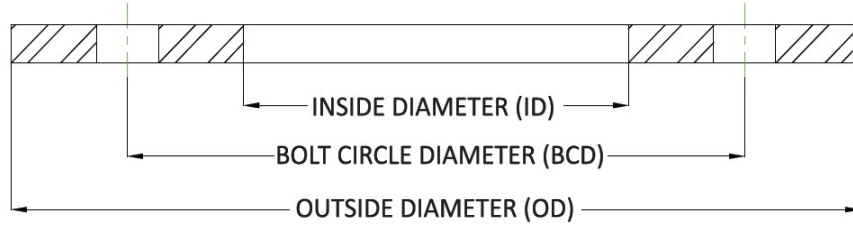

Nominal Pipe Size (NPS)	Class 900				
	Inside Diameter (ID)	Outside Diameter (OD)	# of Bolt Holes	Bolt Hole Diameter (Inches)	Bolt Circle Diameter (BCD)
	mm	mm	Inches		mm
1/2"	21	121	4	0.88	82.6
3/4"	27	130	4	0.88	88.9
1	33	149	4	1	101.6
1 1/4	42	159	4	1	111.3
1 1/2	49	178	4	1.13	124
2	60	216	8	1	165.1
2 1/2	73	245	8	1.13	190.5
3	89	241	8	1	190.5
3 1/2	102	292			
4	114	292	8	1.25	235
5	141	349	8	1.38	279.4
6	168	381	12	1.25	317.5
8	219	470	12	1.5	393.7
10	273	546	16	1.5	469.9
12	324	610	20	1.5	533.4
14	356	641	20	1.63	558.8
16	406	705	20	1.75	616
18	457	787	20	2	685.8
20	508	857	20	2.13	749.3
24	610	1041	20	2.63	901.7

Dimensions for Full Face Gaskets to Suit ASME B16.47 Series A Flanges

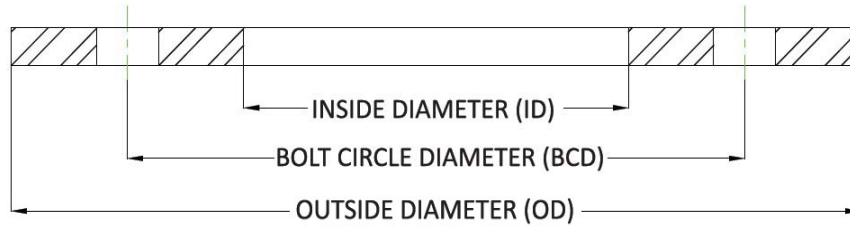

Nominal Pipe Size (NPS)	Class 150					Class 300				
	Inside Diameter (ID)	Outside Diameter (OD)	# of Bolt Holes	Bolt Hole Diameter (Inches)	Bolt Circle Diameter (BCD)	Inside Diameter (ID)	Outside Diameter (OD)	# of Bolt Holes	Bolt Hole Diameter (Inches)	Bolt Circle Diameter (BCD)
	mm	mm			mm	mm	mm	Inches		mm
26	660	870	24	1.38	806.5	662	972	28	1.75	876.3
28	711	927	28	1.38	863.6	713	1035	28	1.75	939.8
30	762	984	28	1.38	914.4	764	1092	28	1.88	997
32	813	1060	28	1.63	977.9	815	1149	28	2	1054.1
34	864	1111	32	1.63	1028.7	866	1207	28	2	1104.9
36	914	1168	32	1.63	1085.9	917	1270	32	2.13	1168.4
38	965	1238	32	1.63	1149.4	968	1168	32	1.63	1092.2
40	1016	1289	36	1.63	1200.2	1019	1238	32	1.75	1155.7
42	1067	1346	36	1.63	1257.3	1070	1289	32	1.75	1206.5
44	1118	1403	40	1.63	1314.5	1121	1353	32	1.88	1263.7
46	1168	1454	40	1.63	1365.3	1172	1416	28	2	1320.8
48	1219	1511	44	1.63	1422.4	1223	1467	32	2	1371.6
50	1270	1568	44	1.88	1479.6	1274	1530	32	2.13	1428.8
52	1321	1626	44	1.88	1536.7	1324	1581	32	2.13	1479.6
54	1372	1683	44	1.88	1593.9	1375	1657	28	2.38	1549.4
56	1422	1746	48	1.88	1651	1426	1708	28	2.38	1600.2
58	1473	1803	48	1.88	1708.2	1477	1759	32	2.38	1651
60	1524	1854	52	1.88	1759	1528	1810	32	2.38	1701.8

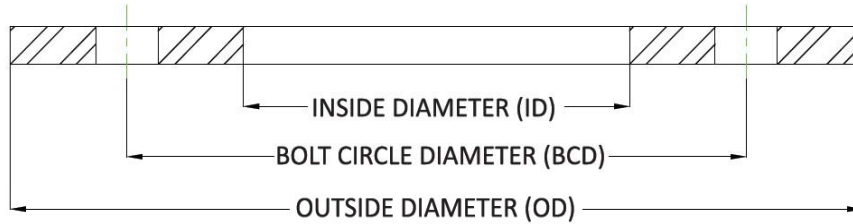
Dimensions for Full Face Gaskets to Suit ASME B16.47 Series B Flanges

Nominal Pipe Size (NPS)	Class 150					Class 300				
	Inside Diameter (ID)	Outside Diameter (OD)	# of Bolt Holes	Bolt Hole Diameter (Inches)	Bolt Circle Diameter (BCD)	Inside Diameter (ID)	Outside Diameter (OD)	# of Bolt Holes	Bolt Hole Diameter (Inches)	Bolt Circle Diameter (BCD)
	mm	mm			mm	mm	mm			mm
26	660	786	36	0.88	744.5	660	867	32	1.38	803.4
28	711	837	40	0.88	795.3	711	921	36	1.38	857.3
30	762	887	44	0.88	846.1	762	991	36	1.5	920.8
32	813	941	48	0.88	900.2	813	1054	32	1.63	977.9
34	864	1005	40	1	957.3	864	1108	36	1.63	1032
36	914	1057	44	1	1009.7	914	1172	32	1.75	1089.2
38	965	1124	40	1.13	1070.1	965	1223	36	1.75	1140
40	1016	1175	44	1.13	1120.9	1016	1273	40	1.75	1190.8
42	1067	1226	48	1.13	1171.7	1067	1334	36	1.88	1244.6
44	1118	1276	52	1.13	1222.5	1118	1384	40	1.88	1295.4
46	1168	1341	40	1.25	1284.2	1168	1461	36	2	1365.3
48	1219	1392	44	1.25	1335	1219	1511	40	2	1416.1
50	1270	1443	48	1.25	1385.8	1270	1562	44	2	1466.9
52	1321	1494	52	1.25	1436.6	1321	1613	48	2	1517.7
54	1372	1549	56	1.25	1492.3	1372	1673	48	2	1578.1
56	1422	1600	60	1.25	1543.1	1422	1765	36	2.38	1651
58	1473	1675	48	1.38	1611.4	1473	1827	40	2.38	1713
60	1524	1726	52	1.38	1662.2	1524	1878	40	2.38	1763.8

Tolerances of ASME B16.21 flat gasket:

Nominal Pipe Size (NPS) 12 and smaller Outside Diameter (OD): +0.0", -1/16" (+0.0, -1.5 mm)

Nominal Pipe Size (NPS) 14 and Larger Outside Diameter (OD): +0.0", -1/8" (+0.0, -3.0 mm)

Nominal Pipe Size (NPS) 12 and smaller Inside Diameter (ID): ± 1/16" (±1.5 mm)

Nominal Pipe Size (NPS) 14 and Larger Inside Diameter (ID): ± 1/8" (±3.0 mm)

Bolt Circle Diameter: ± 1/16" (±1.5 mm)

Center to center of adjacent bolt holes: ±1/32" (±1.0 mm)

Dimensions for Ring Gaskets per EN1514-1(DIN2690) flanges

DN	d	D							
		PN 2 5	PN 6	PN 10	PN 16	PN 25	PN 40	PN 64	PN 100
10	18	38	38	45	45	45	45	56	56
15	22	43	43	50	50	50	50	61	61
20	28	53	53	60	60	60	60	72	72
25	35	63	63	70	70	70	70	82	82
32	43	75	75	82	82	82	82	88	88
40	49	85	85	92	92	92	92	103	103
50	61	95	95	107	107	107	107	113	120
65	77	115	115	127	127	127	127	138	145
80	90	132	132	142	142	142	142	148	155
100	115	152	152	162	162	168	168	175	180
125	141	182	182	192	192	195	195	210	217
150	169	207	207	218	218	225	225	247	257
175	195	237	237	248	248	255	267		
200	220	262	262	273	273	285	292	309	324
250	274	318	318	328	330	342	353	364	391
300	325	373	373	378	385	402	418	424	458
350	368	423	423	438	445	458	475	486	512
400	420	473	473	490	497	515	547	588	627
450	470	528	528	540	557	565	572	657	704
500	520	578	578	595	618	625	628	764	813
600	620	680	680	695	735	730	745	579	950
700	720	785	785	810	805	830	850	988	
800	820	890	890	915	910	940	970	1108	
900	920	990	990	1015	1010	1040	1080	1220	
1000	1020	1090	1090	1120	1125	1150	1190		
1200	1220	1290	1305	1340	1340	1360	1395		
1400	1420	1490	1520	1545	1540	1575	1615		
1600	1620	1700	1720	1770	1760	1795	1830		
1800	1820	1900	1930	1970	1960	2000			
2000	2020	2100	2135	2180	2165	2230			
2200	2220	2305	2345	2380	2375				
2400	2420	2505	2555	2590	2585				
2600	2620	2705	2760	2790	2785				
2800	2820	2920	2970	3010					
3000	3020	3120	3170	3225					
3200	3220	3320	3380						
3400	3420	3520	3590						
3600	3620	3730	3800						
3800	3820	3930							
4000	4020	4130							

Tolerances:

d up to 600 ±0.4 mm
 over 600 + 0mm, -3.2mm

D up to 600 ±0.4 mm
 over 600 + 0mm, -3.2mm